

nuna®



pipa™ series
organic cotton insert

Designed
around your life



**IMPORTANT!
KEEP THESE
INSTRUCTIONS FOR
FUTURE REFERENCE:**
READ CAREFULLY

Contents

Product Information	
Warranty	4
Contact	4
Usage Requirements	5
Warnings	6
Parts List	7
Product Use	8
Cleaning and Maintenance	10

Product Information

Model Number: _____

Manufactured in (date): _____

Please fill in the above information. The model number and the manufactured in date are located on the bottom of the carton.

Warranty

We have purposely designed our high-quality products so that they can grow with both your child and your family. Because we stand by our product, our gear is covered by a custom warranty per product, starting from the day it was purchased. Please have the proof of purchase, model number and manufactured in date available when you contact us.

For warranty information please visit:

www.nunababy.com/warranty

Contact

For replacement parts, service, or additional warranty questions, please contact our customer service department.

In the USA:

infousa@nunababy.com

www.nunababy.com

1.855.NUNA.USA

Usage Requirements

The PIPA series organic cotton insert can be used with PIPA and the PIPA lite series as necessary, to provide a snug fit for small babies.

For PIPA and PIPA lite series assembly and usage, please refer to their instruction manuals.

The low birth weight pillow (located on the back of the body support) can be used in the body support for even smaller babies, but **MUST** be removed once a snug fit can be achieved without it, at approximately 11 lb.

⚠️ WARNING

Failure to follow these warnings and instructions could result in serious injury or death.

A child's safety is your responsibility. **NEVER** leave your child unattended.

If child is not secured properly, child could be ejected in a sudden stop or crash, resulting in serious injury or death.

Snugly adjust the belts provided with this child restraint around your child. If straps are not snugly adjusted, child may be ejected from seat in the event of an accident.

A snug strap should not allow any slack. It lies in a relatively straight line without sagging. It does not press on the child's flesh or push the child's body into an unnatural position.

Make sure that nothing interferes with the harness. Make sure harness is snug around child and lays flat.

NEVER use clothing or blankets that interfere with providing a properly tightened harness. An unsecured or improperly harnessed child can come out of the restraint during a crash. Place blankets over child **AFTER** harness has been properly tightened.

Only use with Nuna PIPA or PIPA lite series.

Parts List

- 1 Head Support
- 2 Body Support
- 3 Low Birth Weight Pillow (located on the back of the body support)
- 4 Crotch Belt Slot

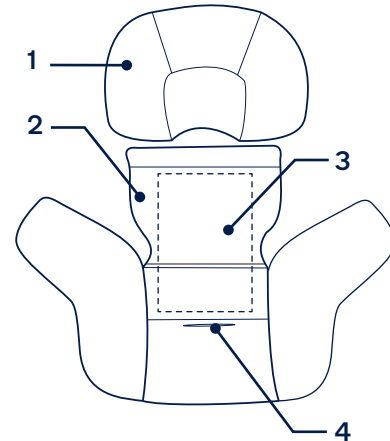

Product Use

Head and Body Support

The head and body supports can be used as necessary, to provide a snug fit for small babies.

⚠ The head support straps cannot go through the same slots as the harness and should only be used in the top two harness slot positions.

- 1 - Insert the head support straps through the harness slots.
- 2 - Then fasten the hook and loop ends behind the seat fabric.
- 3 - To insert the body support, unbuckle the harness and route the buckle and crotch belt through the bottom slot of the body support.
- 4 - The low birth weight pillow (located on the back of the body support) can be used in the body support for even smaller babies, but **MUST** be removed once a snug fit can be achieved without it. The pillow **MUST** be removed when the child reaches 11 lb.
- 5 - To remove the low birth weight pillow, unfasten the hook and loop on the back of the body support and pull out the pillow.
- 6 - **⚠** Harness straps must be at or just below child's shoulders to avoid injury. If harness slots need to be moved refer to the instructions in the PIPA or PIPA lite series instruction manuals.

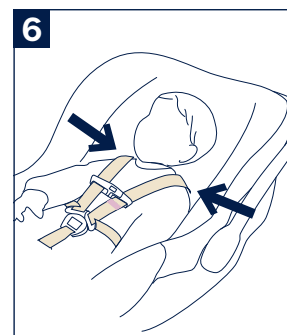
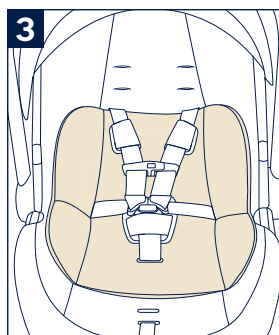
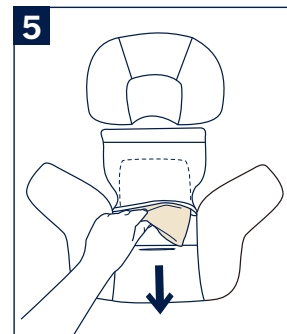
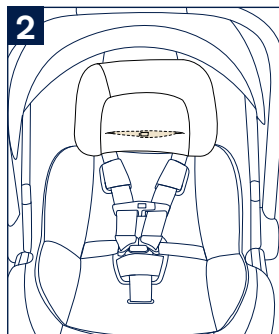
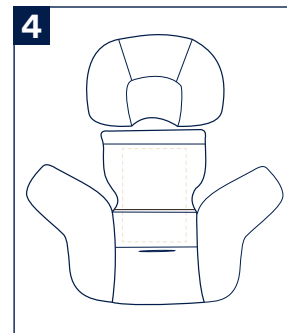
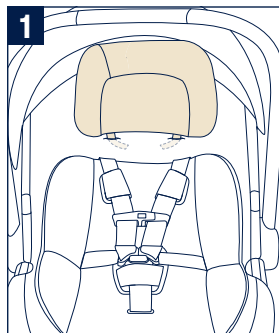

Cleaning and Maintenance

Refer to the care label attached to the soft goods for washing and drying instructions. Remove the low birth weight pillow before washing.

It is normal for fabric to color from sunlight and to show wear and tear after a long period of use, even when used normally.

IM-0259B



Nuna Baby Essentials, Inc.

70 Thousand Oaks Blvd. | Morgantown, PA 19543

1.855.NUNA.USA | nunababy.com